

# Exteriors and Floor Plans

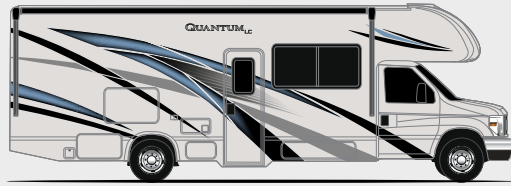

QUANTUM LC - STANDARD GRAPHICS



QUANTUM PARTIAL PAINT - BLUE OYSTER



QUANTUM PARTIAL PAINT - PEARL WHITE



QUANTUM FULL BODY PAINT - LAKE TAHOE



QUANTUM FULL BODY PAINT - SILVER CREEK

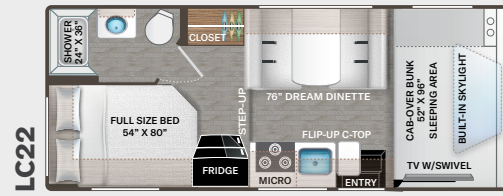

LC22

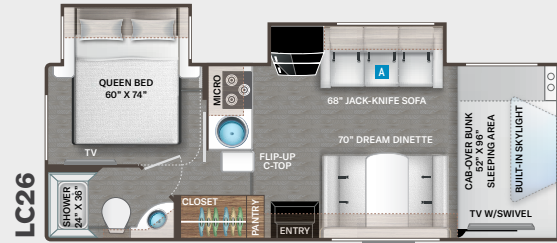

LC26

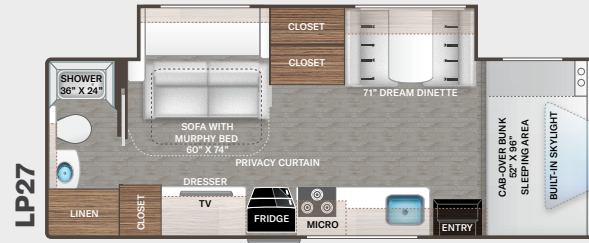

LP27

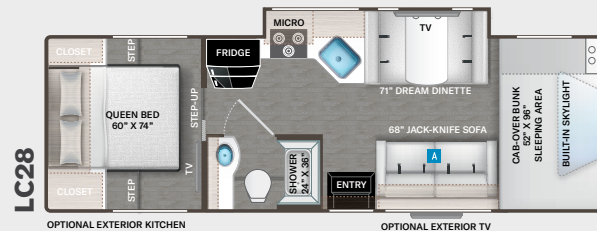

LC28

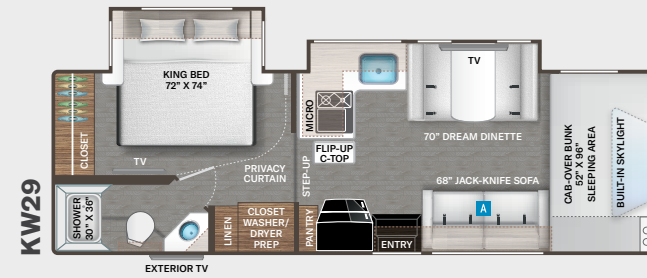

KW29

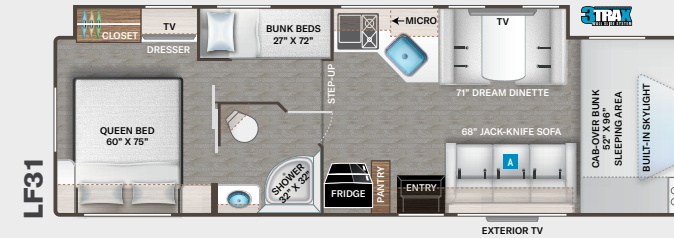

LF31

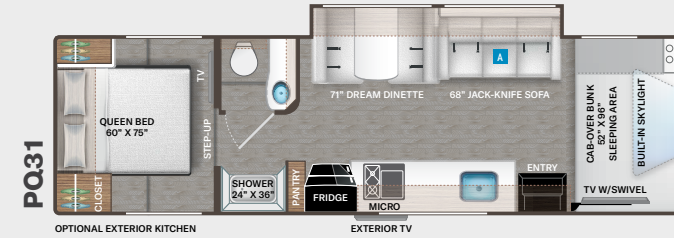

PQ31

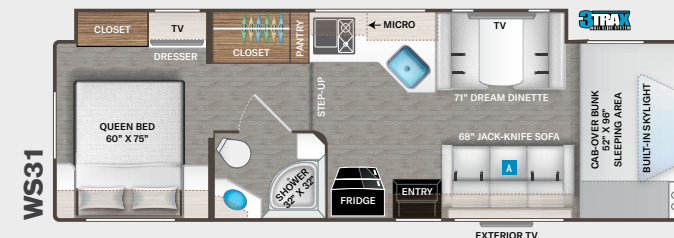

WS31

## Interiors

KW29, LF31, PQ31, WS31 ONLY



CALI COLLECTION  
LC22, LC26, LP27 & LC28  
OPTIONAL ON KW29, LF31, PQ31, WS31



Option Available on  
Select Floor Plans:

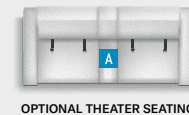

OPTIONAL THEATER SEATING



Use your phone's camera to  
find out more information.  
Just scan the code!

# QUANTUM® & QUANTUM<sup>LC</sup>

# Featured Highlights

## CONSTRUCTION & EXTERIOR

- Ford® E-Series Chassis - 7.3L V8, 325HP & 450 lb-ft Torque - w/TPM's
- Electric Stabilizing System (LC26 & LP27)
- Automatic Leveling Jacks with Touchpad Controls (KW29, LF31, PQ31, & WS31)
- SmoothTECH™ Ride Enhancement (KW29, LF31, PQ31 & WS31)
- Standard Graphics Package (LC22, LC26, LP27 & LC28)
- Partial Paint with Graphics Package (KW29, LF31, PQ31 & WS31)
- Front Cap with Skylight & Power Shade
- Lighted Rotocast Storage Compartments with Single ON/OFF Interior Switch
- MEGA-Storage™ Compartment (LC22, LC28, LF31, PQ31 & WS31)
- Portable Table in Mega Storage Compartment (LC28 & PQ31)
- Premium One-Piece Crossflex™ Roofing
- Framed Windows (LC22, LC26, LP27 & LC28)
- Frameless Windows (KW29, LF31, PQ31 & WS31)
- Power Patio Awning w/Integrated LED Lighting

## CONSTRUCTION & EXTERIOR OPTIONS

- Chevy® Chassis - 6.6L V8, 401HP & 464 lb-ft Torque (LC22 & LC26)
- Full-Body Paint Package with Protective Mask (KW29, LF31, PQ31 & WS31)
- Exterior Pull-out Kitchen with Griddle and 12-volt Cooler (LP27, LC28 & PQ31)

## AUTOMOTIVE & COCKPIT

- 7" Touchscreen Dash Radio, Apple CarPlay™, Android Audio® with Back-Up Monitor (LC22, LC26, LP27 & LC28)
- 10" Touchscreen Dash Radio, Apple CarPlay™, Android Audio® with Back-Up Monitor (KW29, LF31, PQ31 & WS31)
- SiriusXM® Tuner & Antenna
- Tilt Steering Wheel with Audio & Camera Controls (Ford® E-Series Chassis Only)
- Keyless Entry System
- Deluxe Exterior Mirrors (LC22, LC26, LP27 & LC28)
- Emergency Engine Start Switch
- Aluminum Running Boards
- Stainless Steel Wheel Liners
- Valve Stem Extenders
- Cruise Control

- Windshield Privacy Curtain
- LED Taillights

## AUTOMOTIVE & COCKPIT OPTIONS

- Heated/Remote Exterior Mirrors with Integrated Side View Cameras (STD - KW29, LF31, PQ31 & WS31)
- Leatherette Captain's Chairs (STD - KW29, LF31, PQ31 & WS31)
- Power Driver's Seat (KW29, LF31, PQ31 & WS31)

## INTERIOR

- Ceiling Ducted Air Conditioning System (N/A - LC22)
- Flat Panel Cabinet Doors with Nickle Finish Hardware (KW29, LF31, PQ31 & WS31)
- Cali Collection: Flat Panel Two-toned Cabinetry (LC22, LC26, LP27 & LC28)
- Pressed Laminate Countertops
- LED Lighting
- Leatherette Sofa with Queen Size Murphy Bed Conversion (LP27)
- Leatherette Jack-Knife Sofa (LC26, LC28, KW29, LF31, PQ31, & WS31)
- Leatherette Dream Dinette® Booth
- Wireless Phone Charger with USB Charging Port at Dinette
- Single Child Safety Tether in Dinette (N/A LP27)
- Dual Child Safety Tether in Dinette (LP27)
- Cab-Over Sleeping Area with Cup Holders, and Telescoping Bunk Ladder
- Window Privacy Shades (LC22, LC26, LP27 & LC28)
- Premium Window Privacy Roller Shades (KW29, LF31, PQ31 & WS31)
- Electric Fireplace with Remote Control (LP27)
- Ceiling Vent in Cab-Over Bunk

## INTERIOR OPTIONS

- Cali Collection: Two-Toned Flat Panel Cabinetry (KW29, LF31, PQ31 & WS31)
- Leatherette Theater Seating IPO Sofa (LC26, LC28, KW29, LF31, PQ31 & WS31)
- Cab-Over Child Safety Net (KW29, LF31, PQ31 & WS31)
- 12-volt Attic Fan with Cover in Cab-Over Bunk (KW29, LF31, PQ31 & WS31)

## KITCHEN

- 12-volt Refrigerator with AGS

- Recessed 3-Burner Gas Cooktop/Oven with Glass Cover & Range Hood with Task Lighting (LC22, LC26, LP27 & LC28)
- 2-Burner Gas with Single Induction Cooktop (KW29, LF31, PQ31 & WS31)
- Microwave Oven (LC22, LC26, LP27 & LC28)
- 30" Over-the-Range Convection Microwave Oven (KW29, LF31, PQ31 & WS31)
- Flip-Up Countertop Extension (LC22, LC26 & KW29)
- Pop-Up Countertop Outlet & Charging Center (LP27, LC28, KW29, LF31, PQ31 & WS31)
- Pressed Laminate Kitchen Countertops (LC22, LC26, LP27 & LC28)
- Solid Surface Kitchen Countertops with Stainless Steel Sink Covers (KW29, LF31, PQ31 & WS31)
- Large Single Bowl Stainless Steel Sink with Single Handle Faucet with Pull-Down Sprayer
- Kitchen Countertop Accent Lighting
- Kitchen Pantry Cabinet (LC26, KW29, LF31, PQ31 & WS31)
- 12-volt Ceiling Vent with Under-cabinet Switch

## BEDROOM & BATHROOM

- Full Size Bed (LC22)
- Queen Size Bed (LC26, LC28, LF31, PQ31 & WS31)
- Queen Size Murphy Bed (LP27)
- King Size Bed (KW29)
- Hallway Bunk Beds with Telescoping Ladder (LF31)

- USB Power Charging Center in Bedroom
- Bedroom 12-volt Outlet for CPAP Machine
- Ceiling Vent in Bedroom (LC22, LC26, LP27 & LC28)
- 12-volt Attic Fan with Cover in Bedroom (KW29, LF31, PQ31 & WS31 - N/A with Dual A/C Option)
- Power Bath Vent with Wall Switch
- Foot Flush Toilet
- Stainless Steel Bathroom Sink
- Skylight in Shower
- Upgraded Shower Curtain (LC22)
- Shower with Curved Anti-Microbial Shower Curtain (LC26, LP27 & LC28)
- Shower with Glass Door (KW29, LF31, PQ31 & WS31)
- Bathroom Robe Hook(s)

## ENTERTAINMENT

- 39" Smart TV on Manual Swivel in Cab-Over (LC22, LC26 & PQ31)
- 39" Smart TV in Living Area (LP27, LC28, KW29, LF31 & WS31)
- 32" Smart TV in Bedroom (LC26, LC28, KW29, LF31, PQ31 & WS31)
- Satellite Mounting Backer in Roof

## ENTERTAINMENT OPTIONS

- Exterior 32" TV on Swivel Bracket with Bluetooth® Built-in Sound Bar and Radio (STD - KW29, LF31, PQ31 & WS31 / N/A - LC22)

## ELECTRICAL & PLUMBING

- 4.0 kw Gas Generator
- Automatic Generator Start
- Automatic Transfer Switch with Power Protection
- 30-amp Shoreline Power Cord
- Second Auxiliary House Battery (LC22, LC26, LP27 & LC28)
- Single Group 31 AGM House Battery (KW29, LF31, PQ31 & WS31)
- Battery Tray for Four (4) Batteries
- Solar Prep - Includes Solar Controller
- Winegard® Connect™ 2.0 WiFi/4G/TV Antenna
- Tankless Water Heater
- Single, High Output, Roof Air Conditioner
- Outside Shower (LC22, LC26, KW29, LF31 & WS31)
- Exterior Water Spray Port (LP27, LC28 & PQ31)
- 360° Siphon® RV Holding Tank Vent Cap
- 1" Fresh Water Tank Drain
- Black Tank Flush System
- Stackable Washer/Dryer Prep (KW29)
- Systems Control Center
- Exterior LP Connection (N/A - LC22 & LC26)

## ELECTRICAL & PLUMBING OPTIONS

- 100-watt Solar Charging System with Power Controller (STD - LP27, LC28, KW29, LF31, PQ31 & WS31)

- Dual Roof Air Conditioners IPO Standard Roof Air Conditioner (KW29, LF31, PQ31 & WS31)
- Holding Tanks with Heat Pads (STD - KW29, LF31, PQ31 & WS31)



Use your phone's camera to find out more information. Just scan the code!



P.O. Box 1486, Elkhart, IN 46515  
Sales Department: 800.860.5658



# Specifications

	LC22	LC26	LP27	LC28	KW29	LF31	PQ31	WS31
Chassis	Ford / Chevy	Ford / Chevy	Ford	Ford	Ford	Ford	Ford	Ford
Gross Vehicle (GVWR)	12,500 / 12,300	14,500 / 14,200	14,500	14,500	14,500	14,500	14,500	14,500
Gross Combined (GCWR)	18,500 / 16,000	22,000 / 20,000	22,000	22,000	22,000	22,000	22,000	22,000
Wheel Base	158" / 159"	190" / 191"	200"	212"	212"	223"	223"	223"
Exterior Length (w/o ladder)	24'-1" / 24'-7"	27'-7" / 28'-1"	28'-8"	30'	31'	32'-8"	32'-7"	32'-4"
Exterior Height (w/AC)	11'-0"	11'-2"	11'-2"	11'	11'-2"	11'-2"	11'-2"	11'-2"
Exterior Width (w/o mirrors)	99"	99"	99"	99"	99"	99"	99"	99"
Interior Height (living area)	84"	84"	84"	84"	84"	84"	84"	84"
Awning Size	15'	18'	19'-6"	14'	18'	16'	16'	16'
Fuel (gal)	55 / 57	55 / 57	55	55	55	55	55	55
LPG (lbs)	40.9	40.9	40.9	40.9	40.9	40.9	40.9	40.9
Fresh/Waste/Gray Water (gal)	40 / 24.5 / 37	40 / 29 / 25	40 / 37 / 31	40 / 26 / 40	40 / 34.5 / 37	40 / 28 / 28	40 / 26 / 31	40 / 28 / 28
Water Heater (gal)	Tankless	Tankless	Tankless	Tankless	Tankless	Tankless	Tankless	Tankless
Furnace (BTUs)	19,000	30,000	30,000	30,000	30,000	30,000	30,000	30,000
Exterior Storage Capacity (cu. ft.)	50.3	27.3	39.5	104.2	50.4	55.7	107	55.7
Hitch Weight Rating (lbs)	8,000	8,000	8,000	8,000	8,000	8,000	8,000	8,000

For a complete listing of specifications and available features, visit: [thormotorcoach.com/quantum](http://thormotorcoach.com/quantum)

**IMPORTANT-PLEASE READ:** This brochure reflects product design, fabrication, material, components and specifications at the date of printing, which date is disclosed below. Please visit us online at [ThorMotorCoach.com](http://ThorMotorCoach.com) or consult with your selling dealership for the latest in standards, options, specification and technical information. Photographs in the brochure may depict optional equipment or may only be available in certain floor plans. Components, appliances and the chassis may have been manufactured in a calendar year before the vehicle's designated model year. All capacities are approximate. The actual length of the vehicle may differ from that indicated in the brochure due to variances in the manufacturing processes and/or installed components. All dry weights are based on standard model features and do not include optional features or equipment. Component part and appliance manufacturers issue limited warranties covering portions of the vehicle not covered under the limited warranty we issue. Copyright Thor Motor Coach, Inc. © OH 09/15/2023

